

INSTALLATION GUIDE

SUGAR BOMB

SB.W.S

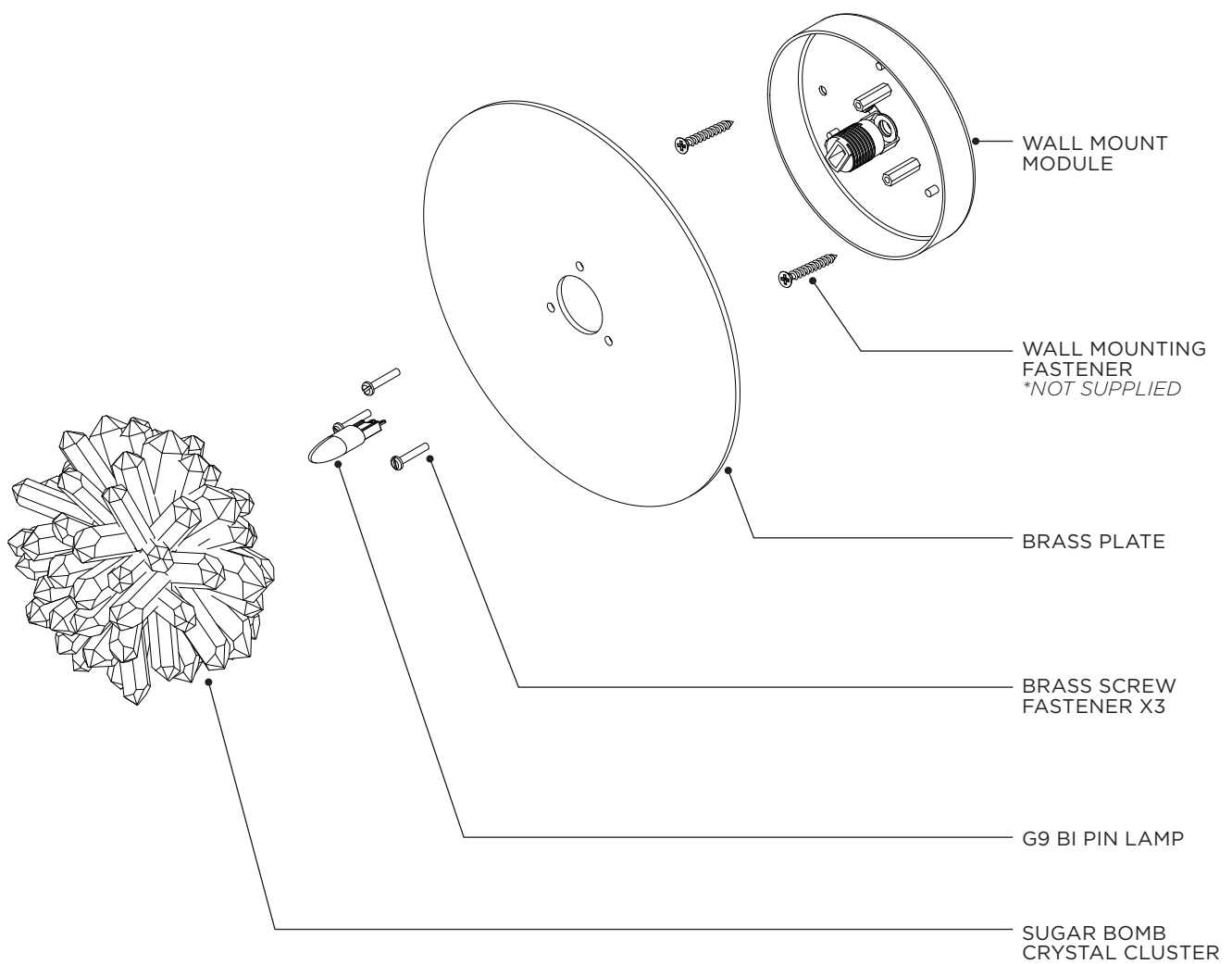

INSTALLATION GUIDE

SUGAR BOMB

SB.W.S



WARNING: SHOCK HAZARD

May result in serious injury or death.
ENSURE POWER IS OFF before commencing any work.



WARNING: ELECTRICAL

ALL ELECTRICAL connections must be made by a qualified electrician in accordance with the regulations and codes governing the area for which the CHRISTOPHER BOOTS Fixture is intended to be installed in. Failure to do so may result in serious harm or damage to property and life, at the owner's liability and expense.

CHRISTOPHER BOOTS will not be held liable for any damage caused from installation.



WARNING: STRUCTURAL

Ensure that the substrate is securely installed and is in accordance with local building regulations. Failure to do so may potentially result in serious harm or damage of property, at the owner's liability and expense.

CHRISTOPHER BOOTS will not be held liable for any damage caused from installation.



Refer to supplied WIRING DIAGRAM.

INSTALLATION GUIDE

SUGAR BOMB

SB.W.S

- 1 Wearing gloves, unpack the SCONE with care ensuring not to scratch component surfaces. Separate the WALL MOUNT MODULE which will be used as a template for SCONE installation. Mark out the TWO wall fixing holes then mark out the power feed hole.v

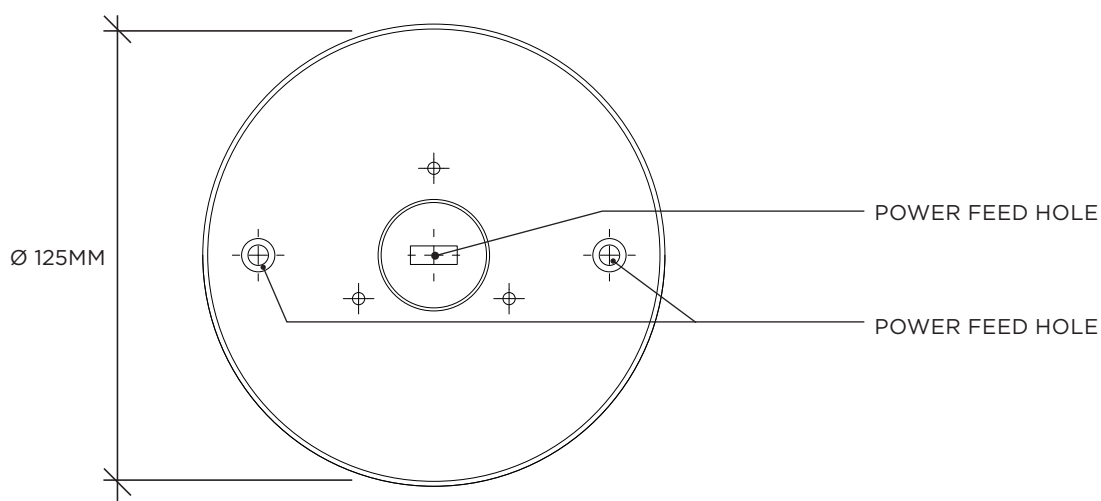

- 2 Remove the WALL MOUNT MODULE and cut the power feed hole.

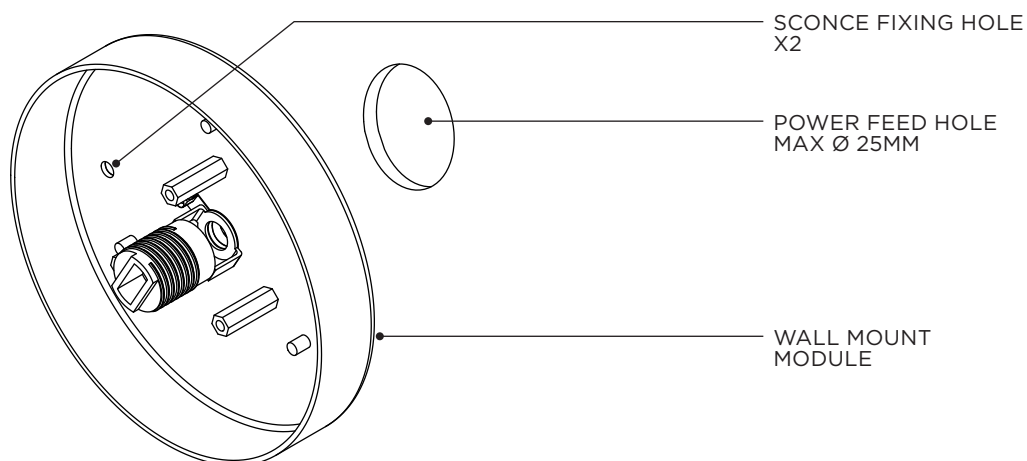

INSTALLATION GUIDE

SUGAR BOMB

SB.W.S

- 3** Connect the 110-240V AC Power to the lamp holders.
Refer to supplied WIRING DIAGRAM →

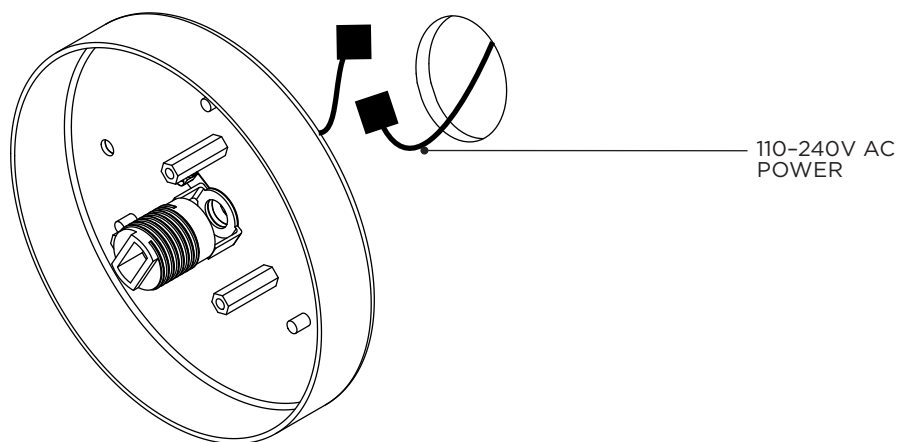

- 4** With the electrical connection made, push back wiring into wall cavity and screw fix WALL MOUNT MODULE to the wall. Ensure the wall fixing fasteners are secured to an adequate load bearing substrate.

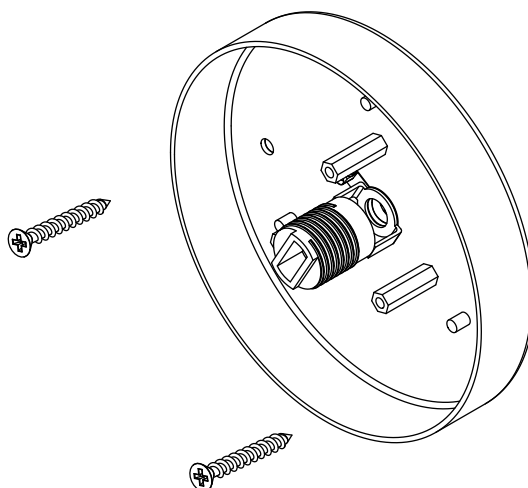

INSTALLATION GUIDE

SUGAR BOMB

SB.W.S

5

With the WALL MOUNT MODULE installed, align and fit the BRASS DISC with the three brass screw fasteners, ensure not to scratch or mark the disc. Insert the lamp and power on to ensure correct working order.

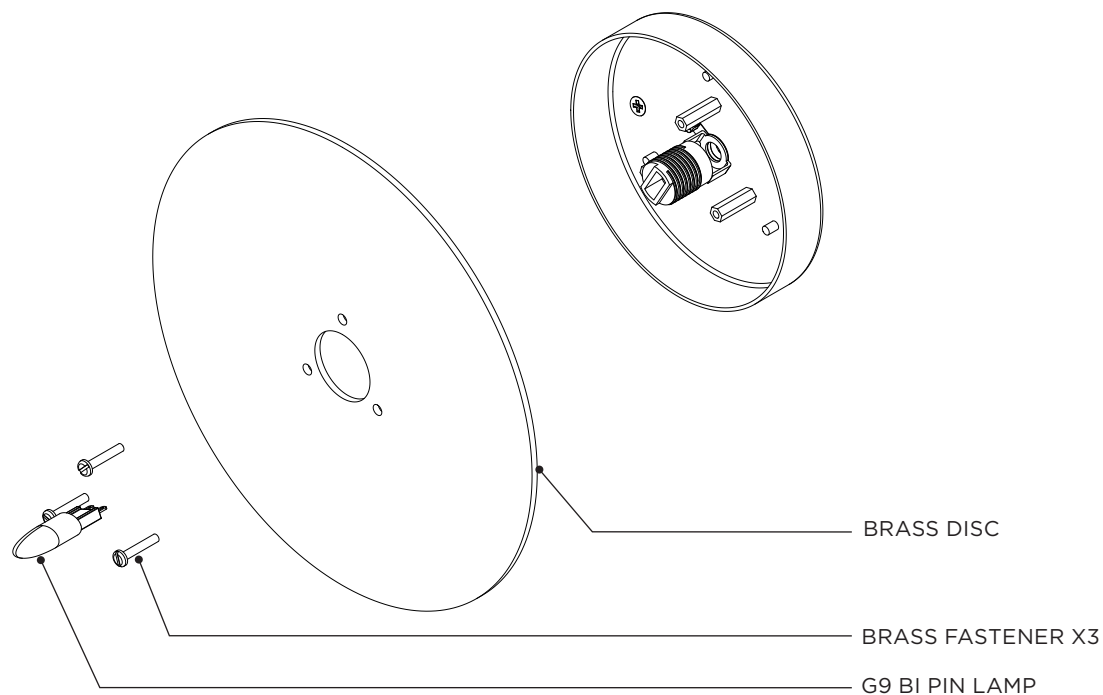

6

Carefully screw on the sugar bomb crystals by winding them in a clock wise direction. These need only to be wound on by hand. Take care not to scratch the BRASS DISC in the process and do not apply excessive turning pressure.

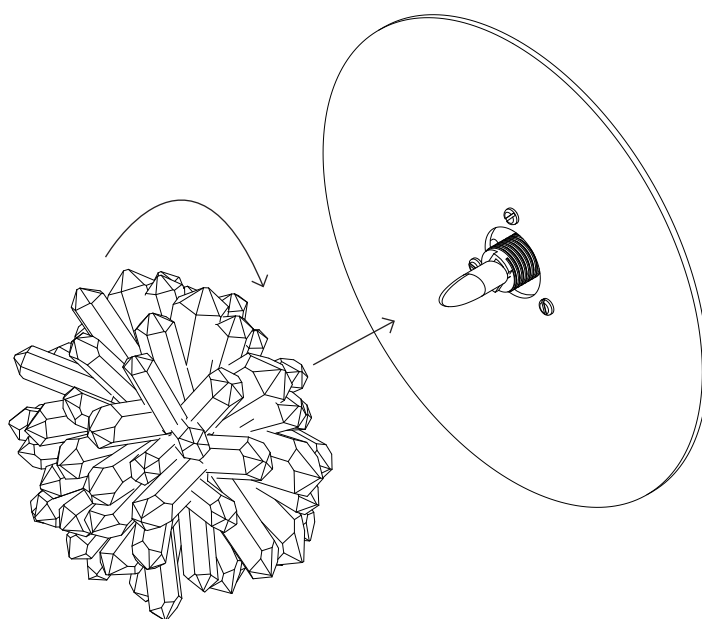

INSTALLATION GUIDE

SUGAR BOMB

SB.W.S

- 7 Switch on the sconce and conduct a final visual assessment to ensure all parts have been properly fitted and secured. Once satisfied that everything is in working order, the installation process is now complete.

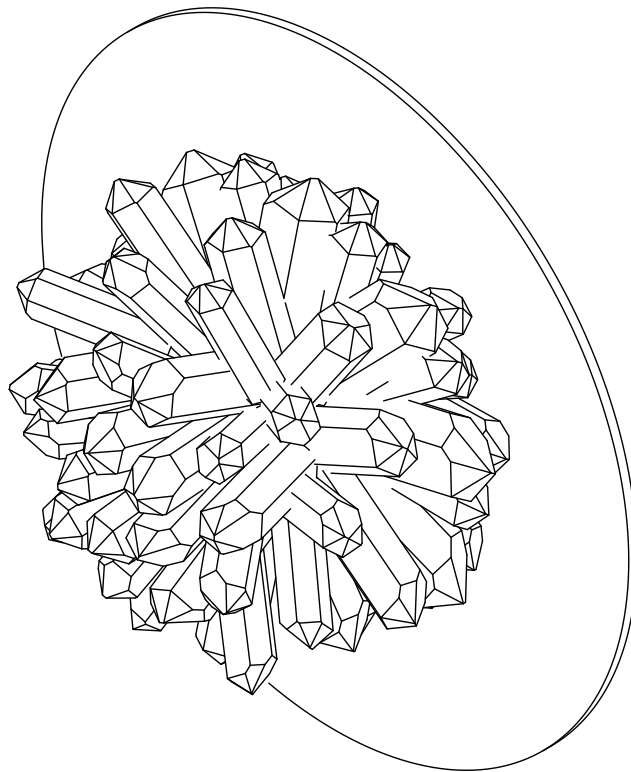

FINISH