

IRIS HENDECA COMPLEX ARRAY

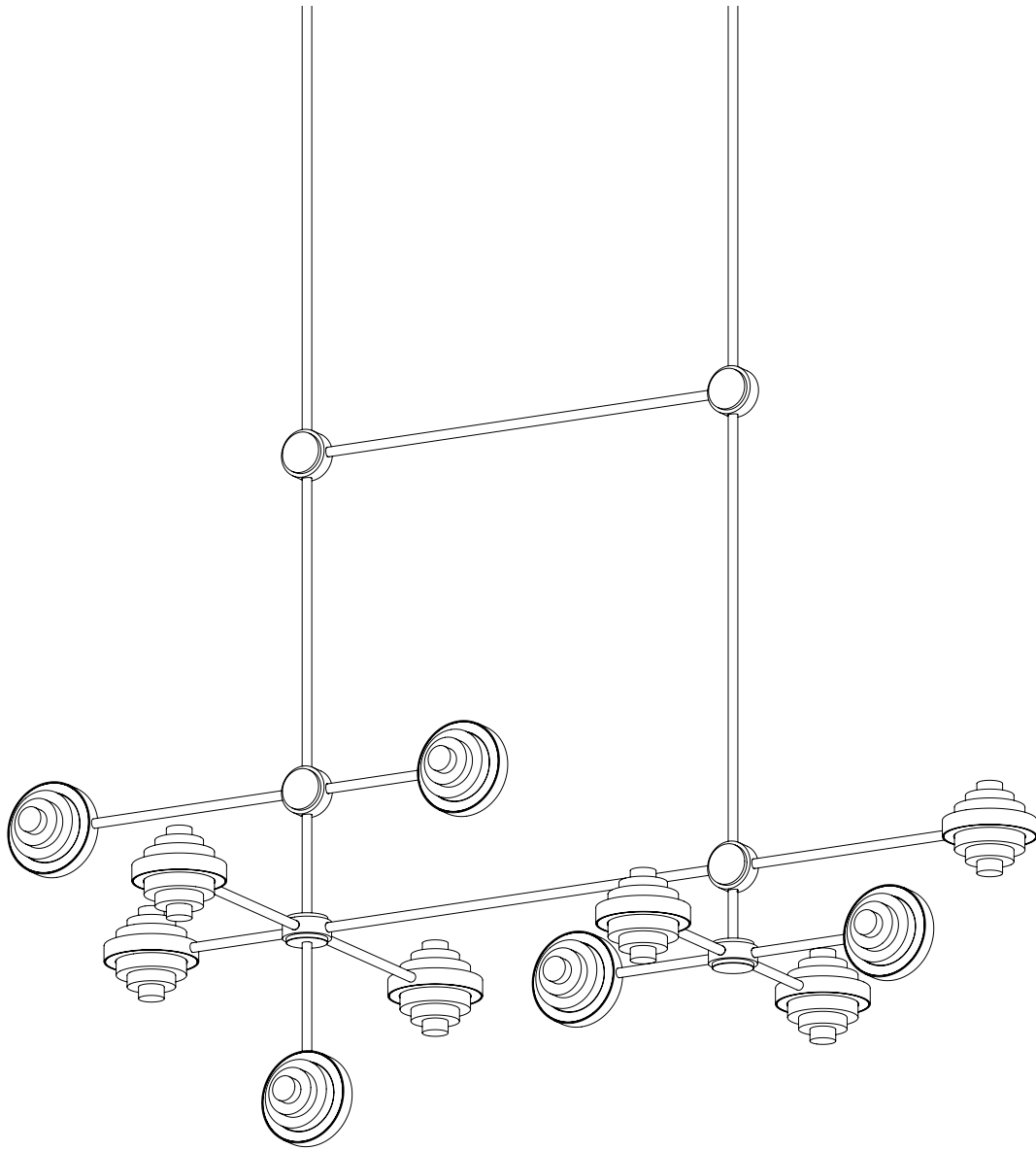

WARNING

ALL ELECTRICAL CONNECTIONS MUST BE MADE BY A QUALIFIED ELECTRICIAN IN ACCORDANCE WITH THE REGULATIONS AND CODES GOVERNING THE AREA FOR WHICH THE CHRISTOPHER BOOTS FIXTURE IS INTENDED TO BE INSTALLED IN. FAILURE TO DO SO MAY RESULT IN SERIOUS HARM OR DAMAGE TO PROPERTY AND LIFE, AT THE OWNER'S LIABILITY AND EXPENSE. CHRISTOPHER BOOTS WILL NOT BE HELD LIABLE FOR ANY DAMAGE CAUSED FROM INSTALLATION.





WARNING: SHOCK HAZARD

May result in serious injury or death.
ENSURE POWER IS OFF before commencing any work.



WARNING: ELECTRICAL

ALL ELECTRICAL connections must be made by a qualified electrician in accordance with the regulations and codes governing the area for which the CHRISTOPHER BOOTS Fixture is intended to be installed in. Failure to do so may result in serious harm or damage to property and life, at the owner's liability and expense.

CHRISTOPHER BOOTS will not be held liable for any damage caused from installation.



WARNING: STRUCTURAL

Ensure that the substrate is securely installed and is in accordance with local building regulations. Failure to do so may potentially result in serious harm or damage of property, at the owner's liability and expense.

CHRISTOPHER BOOTS will not be held liable for any damage caused from installation.



Refer to supplied WIRING DIAGRAM.

- 1 Wearing gloves, unpack the IRIS PENDANT
 - Do not unwrap the PENDANT, in order to prevent any damage that may occur during installation.

- 2 Ensure that the PENDANT is the right way up as per diagram.
 - Begin by unscrewing the 2x CLUSTER BODY CAPS .

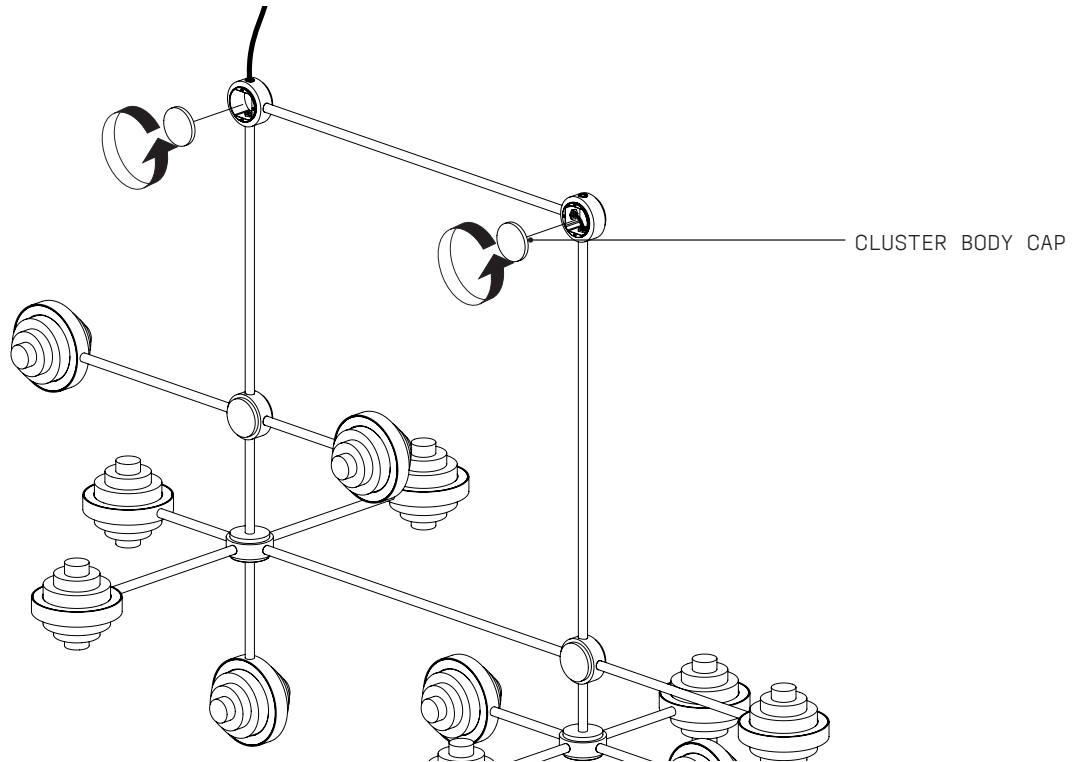

- 3 Loosen the 2x upper most GRUB SCREWS to release the HEX NIPPLE.
 -

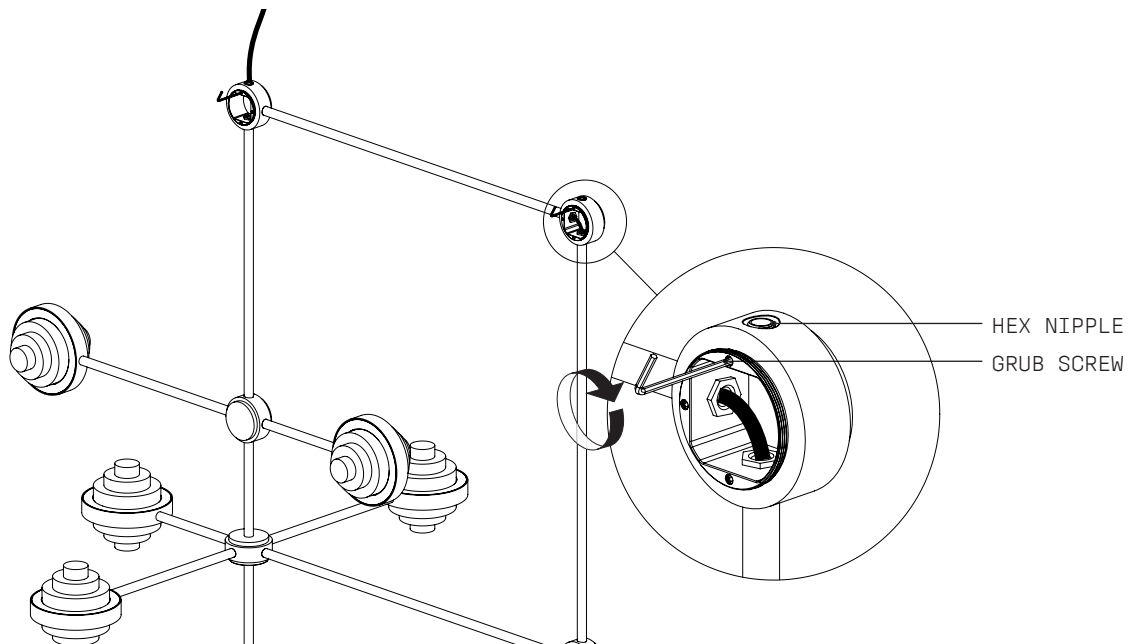

- 4 Feed the 24V DC POWER CABLE from the PENDANT through the SUSPENSION RODS and tightly fasten the tapped end of the rod on to the 2x HEX NIPPLES

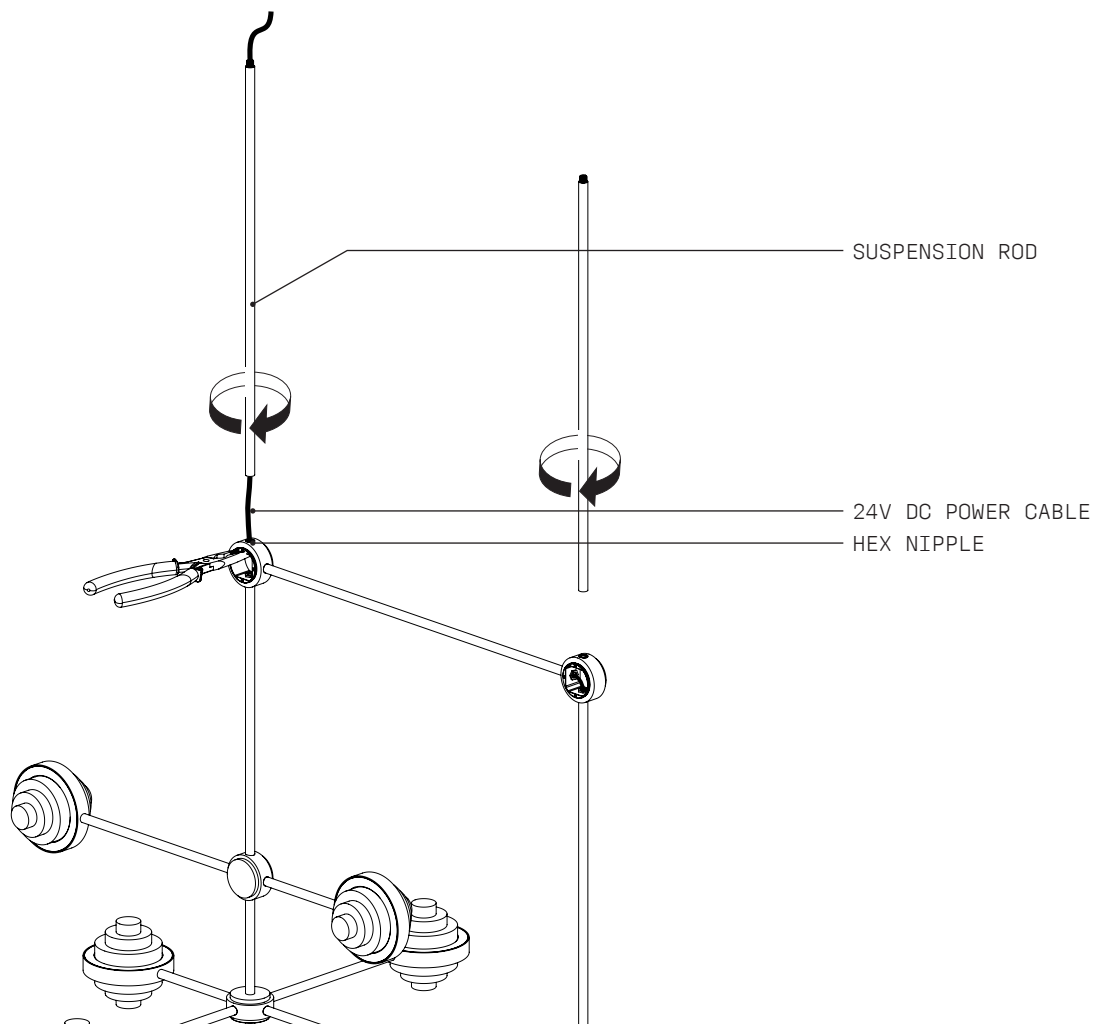

- 5 Tighten the 2x upper most GRUB SCREWS.

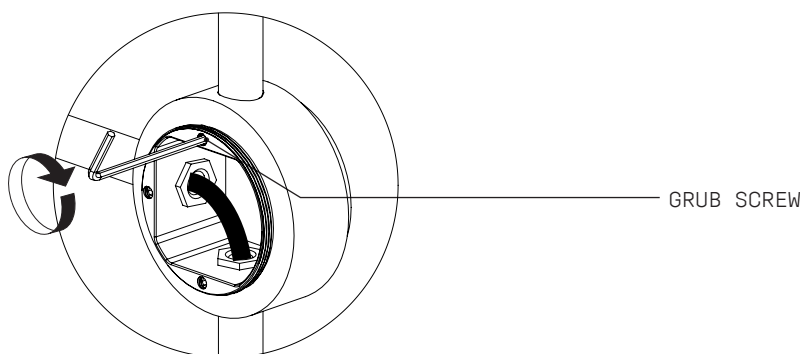

- 6 Replace the 2x CLUSTER BODY CAPS .

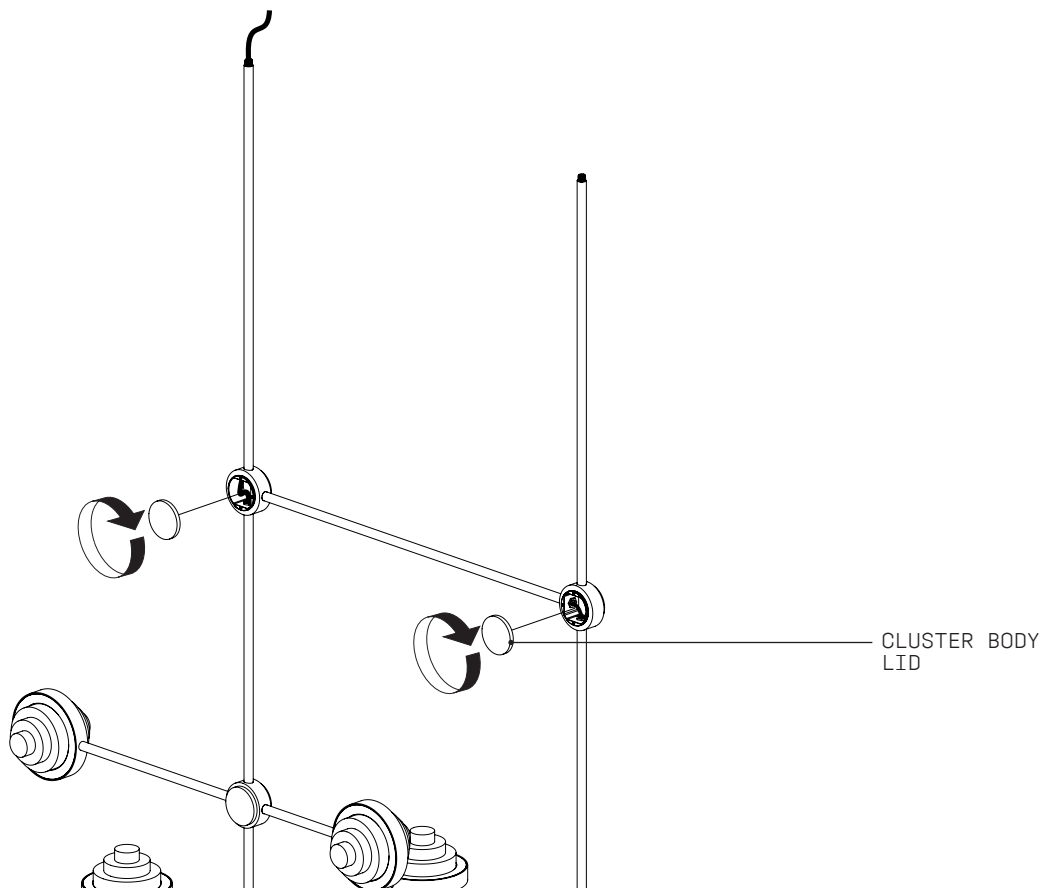

- 7 Next unpack the supplied CEILING CANOPY (illustrations may differ to supplied canopy). Refer to the CANOPY INSTALLATION GUIDE to correctly install all canopy components. Prepare the ceiling utilising the setout below as a guide. Take note of the position of the 24 V DC power exit.

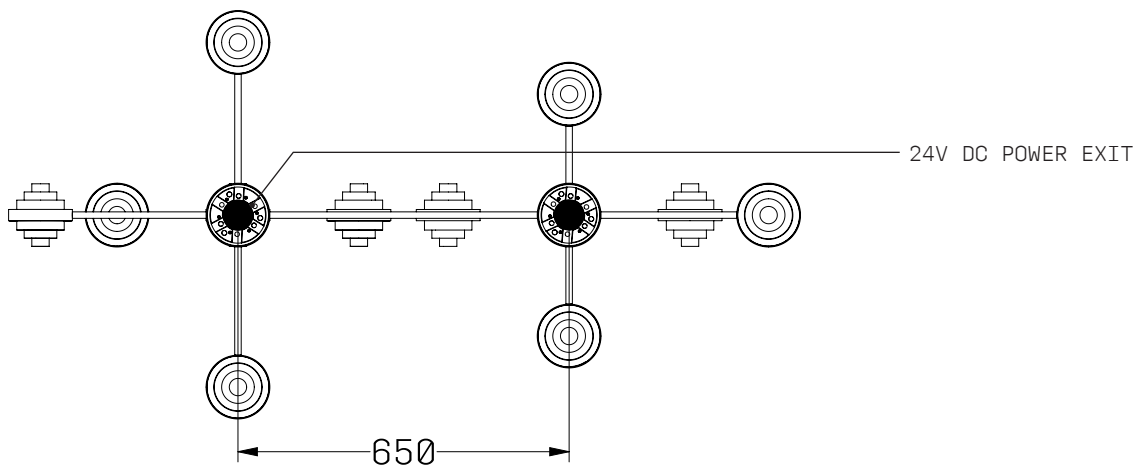

- 8 Conduct a final visual assessment of both the canopies and penant to ensure all parts have been properly fitted and secured. Once satisfied that everything is in working order, remove all remaining protective material which will complete the installation process.

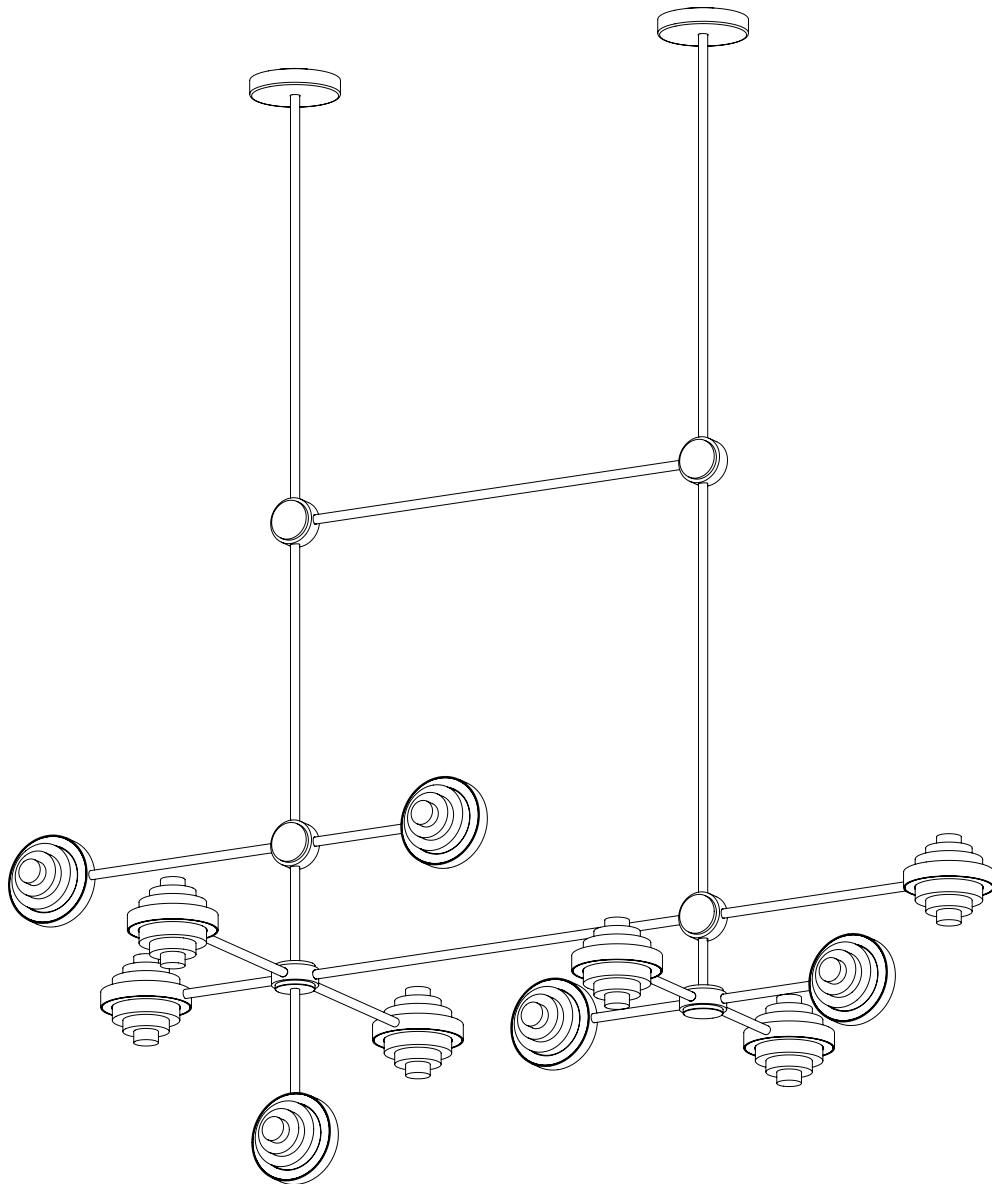

FINISH

CARE INSTRUCTIONS

- IRIS is for indoor use only and operable to a maximum ambient temperature of 25° Celsius. The lamping of this luminaire, is a non-user replaceable source and must only be replaced by CHRISTOPHER BOOTS, an appointed agent and/or qualified professional of CHRISTOPHER BOOTS. Should your pendant require relamping, please contact sales@christopherboots.com to make necessary arrangements.
- Remove dust by simply running an electrostatic duster or dry cloth every few weeks over all external surfaces.
- Take particular care when dusting internal surfaces as these are extremely delicate. A clean lint-free cloth will be ample.
- Under no circumstances should the fixture be cleaned with any type of liquids/detergents or solvents.
- We recommend using micro fibre cloths.
- If more than dusting is required, please contact us at: sales@christopherboots.com

WARRANTY

1. Christopher Boots offers a 36 month / 3 year warranty from date of receipt of balance payment on all light fittings supplied (not installation) against mechanical defects.
2. Christopher Boots will repair or replace defective components or product within this warranty period.

Warranty for components includes:

3. LED lamps and strips: 3 years / 36 months after receipt.
4. LED drivers 60w: 3 years / 36 months after receipt.
5. LED drivers 100w + 150w: 5 years / 60 months after receipt.
6. Incandescent lamps: no warranty – no manufacturer warrants filament lamps.
7. Fixtures are clearly labeled with maximum allowable wattage therefore responsibility of installer / end client to ensure correct lamps & wattages are compliant.
8. Use of higher wattage bulbs than indicated will forfeit warranty.
9. Warranty claims require client to cover shipping enroute back for repair.
10. Any questions? Contact sales@christopherboots.com

CHRISTOPHER BOOTS WILL NOT BE HELD RESPONSIBLE FOR THE FOLLOWING

1. Damage caused by improper cleaning solutions or methods.
2. Damage caused by improper installation or assembly by customer or customer's agent.
3. Damage caused by improper use of light bulbs.
4. Where applicable, installers ensure screwing lamps / glass lamp cover inline with trajectory of product branch + lampholder upon lamp replacement.
5. Where applicable, a screwing motion of slightest angle may cause cross-threading & breakage not covered under warranty.
6. Damage caused by exposure to weather or improper environment – client to check IP rating prior to purchase.
7. Changes in appearance of hand applied finishes or unlacquered finishes.
8. Please note that finishes are designed to age in appearance.
9. Any costs of installation, removal, or re-installation.
10. Restoration, repair work & any parts purchased separately from supplied light fixtures.
11. Damage caused during shipping. All items are packed specifically for global transport.

DAMAGES

1. Damages must be documented and reported within 7 business days of receipt.
2. If external flexible cable of this luminaire is damaged, it shall be exclusively replaced by the manufacturer or your service agent in order to avoid hazard.
3. Photo evidence will be required upon reporting of damage claim.
4. Christopher Boots is not responsible for repair or replacement of damages reported after this time.
5. If damage has occurred in shipping, all packaging must be retained by receiver. Failure to do so may invalidate any claim.

RETURNS

1. Because of the hand-made nature of our product, we unable to offer returns.